

INSTALLATION GUIDE



55000-335 DCT

REPLACEMENT DUCT SMOKE DETECTOR HEAD

BOX CONTENTS

- 55000-335 DCT Duct Smoke Detector Head

EQUIPMENT NEEDED

- Phillips screwdriver
- 1.5 mm Allen Hex Key

TECHNICAL DATA

Sensitivity	3.0 + 1.0 - 1.98 %/ft
Working Voltage	9 V to 33 V DC
Supervisory Current	40-50 μ A at 9V 45-55 μ A at 24V
Surge Current	0 mA
Alarm Current	17 mA at 9v 52 mA at 24V
Operating temperature range	32°F to 140°F
Air Velocity	Refer to specific duct detector documentation
Standards and approval	UL listed component for use in S2829 duct housings
Dimensions	3.93" diameter x 1.65" height
Weight	3.50 oz
Materials	Housing: White flame-retardant polycarbonate Terminals: Nickel plated stainless Steel
Weight	3.50 oz
Test	Magnet or Gemini 501

All data is supplied subject to change without notice.
Specifications are typically at 24V, 73°F and 50% RH unless otherwise specified.

For additional support, installation help, and French and Spanish versions of all materials, please visit :

HEADS.support

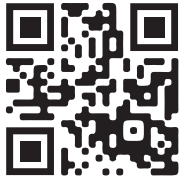

NOTE: For the correct installation of a duct smoke unit, please refer to the NFPA 72 (National Fire Alarm Code), NFPA 90A (Standard for Installation of Air Conditioning and Ventilation Systems), NFPA 92A (Recommended Practice for Smoke Control Systems), NFPA 5000 (Building Construction and Safety Code), IMC (International Mechanical Code), IFC (International Fire Code) and NEC (National Electric Code).

NOTE: For the correct installation of a duct smoke unit in Canada, please refer to the Standard for the installation of Fire Alarm Systems, CAN/ULC -S524 The National Building Code of Canada and the Nation Fire

1. DISCONNECT AND OPEN

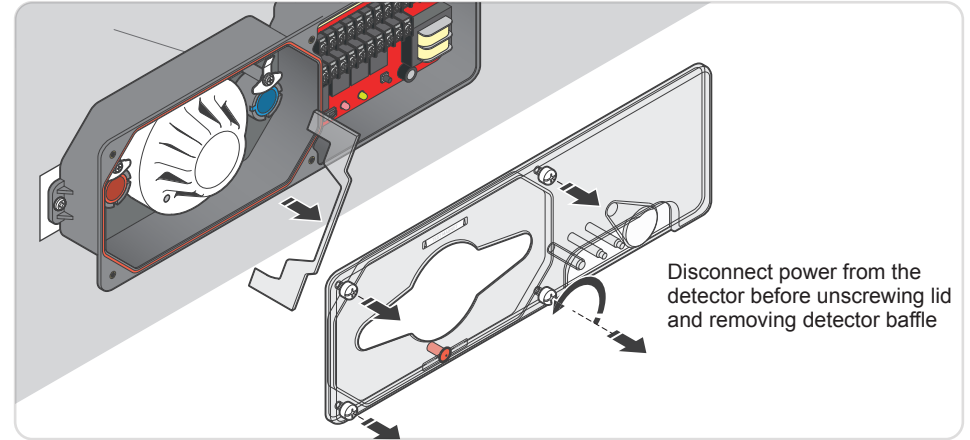

2. REMOVE HEAD

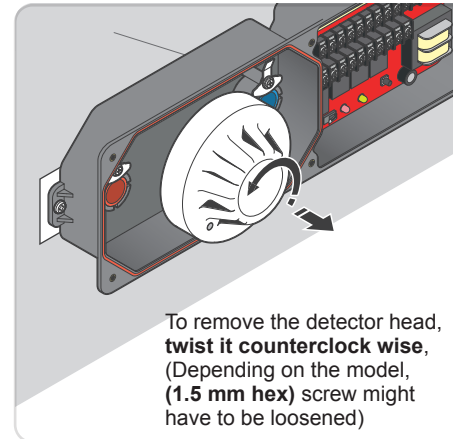

3. ATTACH NEW HEAD

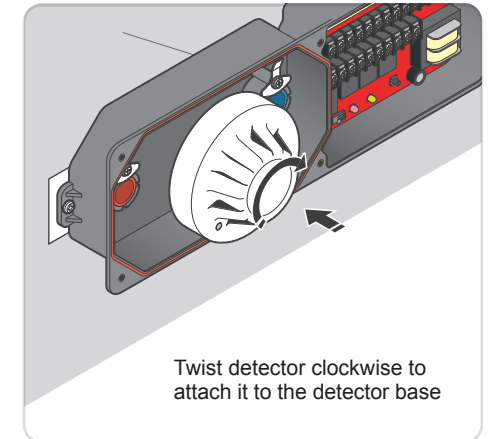

4. REASSEMBLY

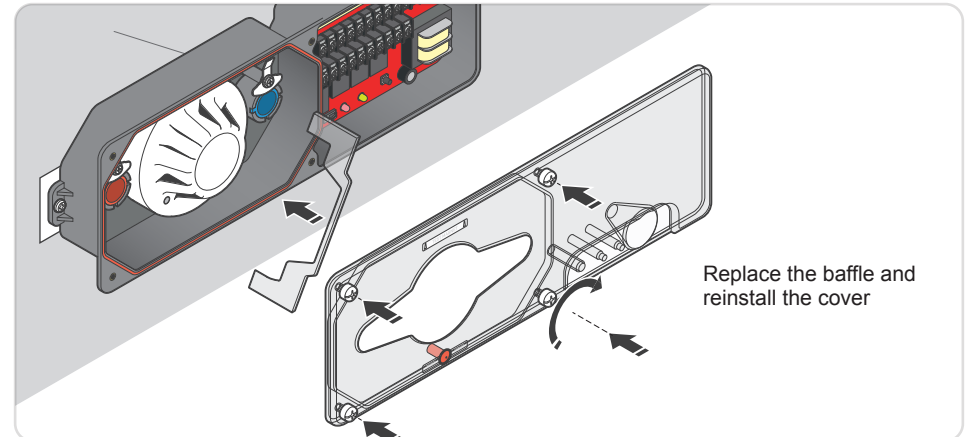

TESTING (RECOMMENDED EVERY 6 MONTHS OR LOCAL NFPA 72 CODE)

WITH GAS

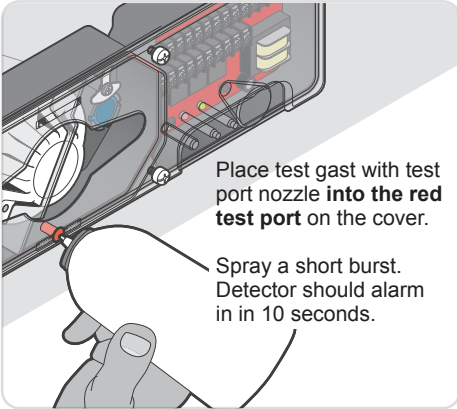

WITH A MAGNET

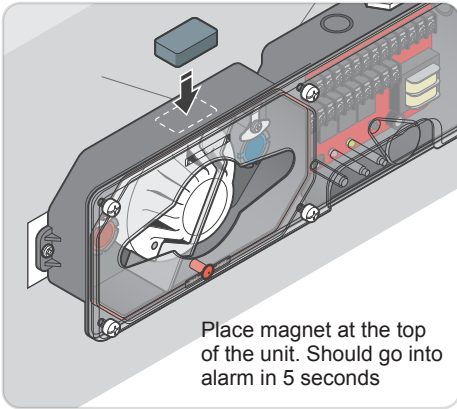

WITH TEST/RESET BUTTON

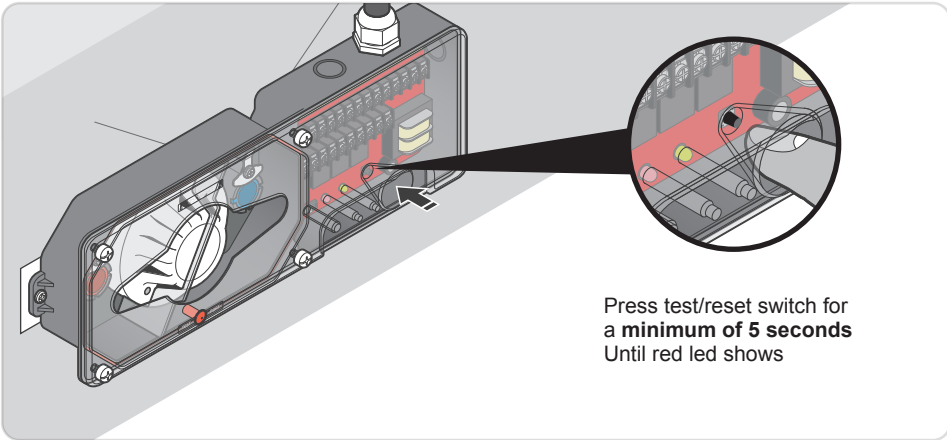

MAINTENANCE (RECOMMENDED QUARTERLY)

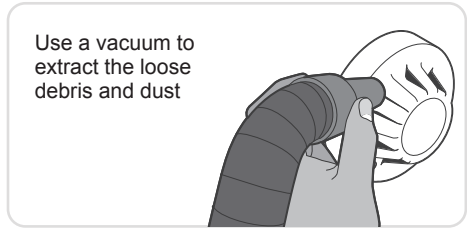
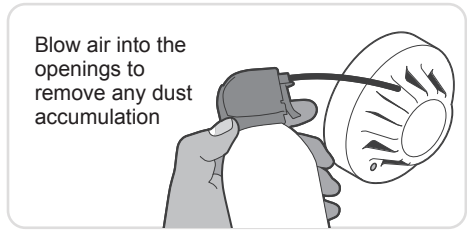
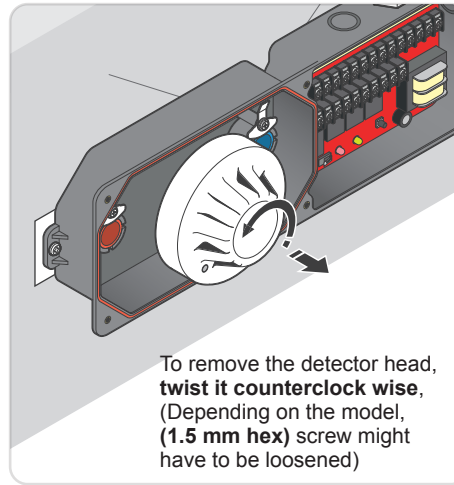
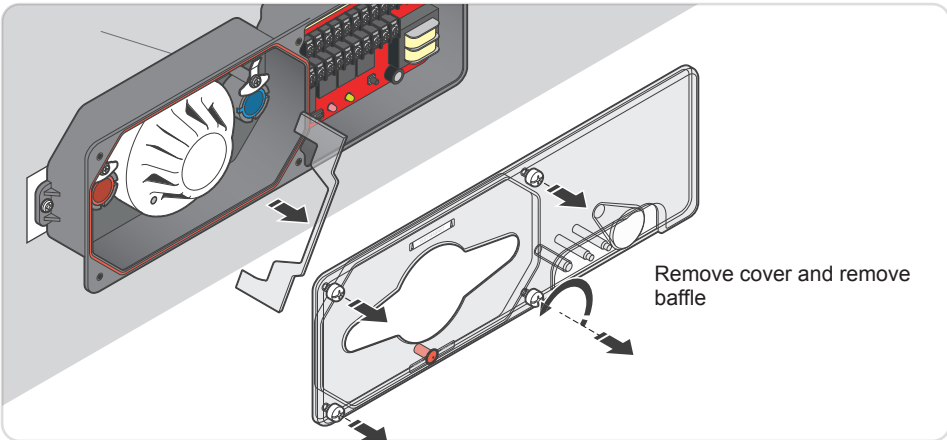

COMPATIBLE DUCT SMOKE DETECTOR HOUSINGS FOR THE SERIES 65 SMOKE DETECTOR HEAD

REFERENCE	DESCRIPTION
SL-2000-P	"Rectangle" Duct Smoke Detector
RT-3000-P	NEMA 4X Duct Smoke Detector
SM-501-P	"Square" Duct Smoke Detector
HS-100-P	Low Airflow Duct Smoke Detector