

Installation Instructions

SHIELD SR02 Surface Remote Cover



Verify System power is OFF before installation.

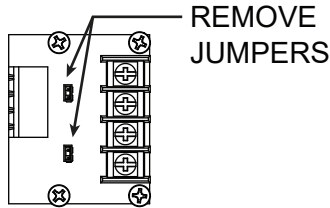
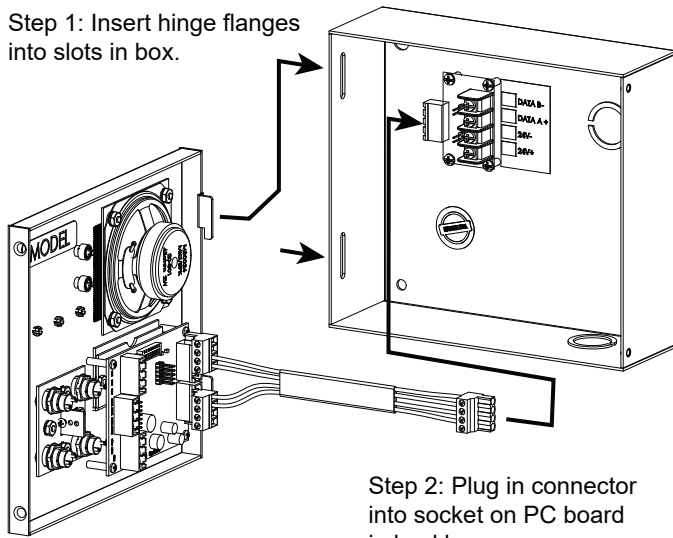

Figure 1

Installation and wiring should be performed by qualified personnel only - Equipment damage and/or malfunction may result from improper installation. All work of any kind shall be performed to meet the requirements of any and all local, state and federal codes and/or standards set by the authority having jurisdiction.

Step 1: Insert hinge flanges into slots in box.



Step 2: Plug in connector into socket on PC board in backbox.

Equipment Supplied

- Shield remote cover assembly.
- Screw kit with (2) 6-32 T15 torx screws and bit.

Installation Procedure

- Remove from packaging and open box.
- Remove screws and bit from screw kit and prepare to assemble.
- REMOVE JUMPERS IN PCB as shown in Figure 1 (If Installed).
- Attach cover to box, slide hinge flanges into slots of back box as shown in 'Step 1'.
- Plug in cable assembly to board in back box as shown in 'Step 2'.
- Address Board as shown in "Module Address Setting" on back of page.
- Close door and secure with (2) 6-32 Torx screws as shown in 'Step 3'.

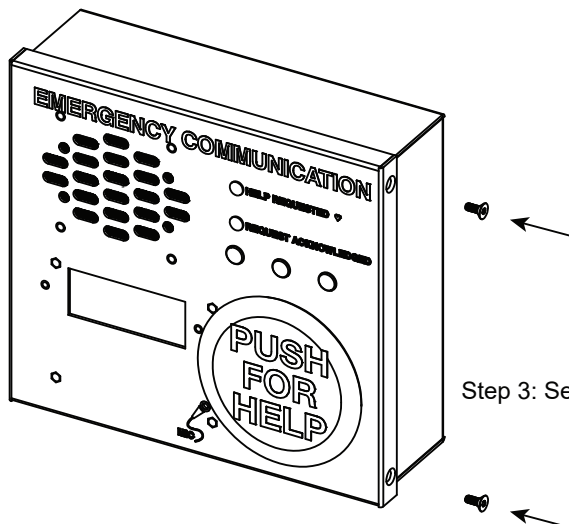

Step 3: Secure door with supplied screws.

Module Address Setting

As shown on board looking at the back of the door.

Reset Switch

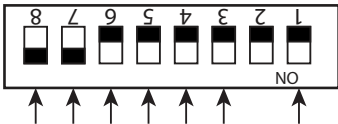
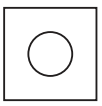

DEFAULT SHIPPING CONFIGURATION SHOWN.
Module Address = 3

Address Value 1 2 4 8 16 32 **EOL**

Switch 1 is EOL. To be switched in on position on last device only.

Addressing is a binary setting. The lowest number that can be used by ANY remote is 3 (default address). To increase the address add all of the switch number values.

Examples:

Address 4

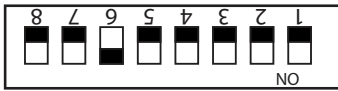

4 = 4

Address 10

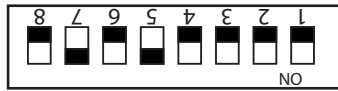

2 + 8 = 10

Address 17

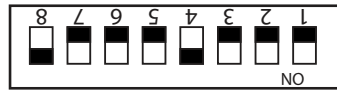

1 + 16 = 17

Down is ON.

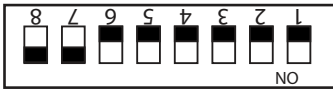

Switch shown as oriented on remote board.

Address:

3		16		29	
4		17		30	
5		18		31	
6		19		32	
7		20		33	
8		21		Address used for Trouble relay.	
9		22		34	
10		23		Last address. Should NOT be used for any remote. May be used for isolator.	
11		24		35	
12		25			
13		26			
14		27			
15		28			